



704 SATIN HOUSE PIAZZA WALK LONDON, E1 8PW

£4,500

A stunning 2-bedroom, 2-bathroom apartment located on the 7th floor of Satin House in the prestigious Goodman's Fields development, E1. This modern home features a spacious open-plan living area, high-spec kitchen with integrated appliances, floor-to-ceiling windows, and private balcony. Residents benefit from 24-hour concierge, on-site gym, pool, spa, and private cinema. Ideally situated within walking distance to Aldgate and Tower Hill stations, offering easy access to the City, Canary Wharf, and beyond. Available furnished.

Hemmingfords

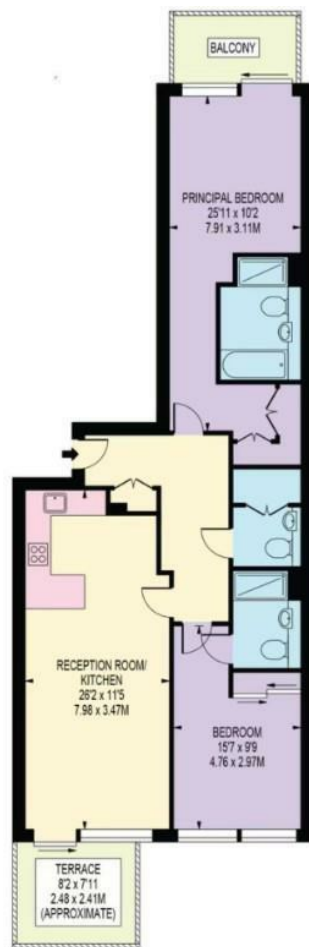

Energy Efficiency Rating		
	Current	Potential
Very energy efficient - lower running costs		
(92 plus) A		
(81-91) B		
(69-80) C		
(55-68) D		
(39-54) E		
(21-38) F		
(1-20) G		
Not energy efficient - higher running costs		
England & Wales	EU Directive 2002/91/EC	

Agents Note: Whilst every care has been taken to prepare these particulars, they are for guidance purposes only. All measurements are approximate and are for general guidance purposes only and whilst every care has been taken to ensure their accuracy, they should not be relied upon and potential buyers/tenants are advised to recheck the measurements

Hemmingfords Lettings & Sales
Second Floor
34 Upper Street
London
N1 0PN

020 3890 7470
info@hemmingfords.co.uk
www.hemmingfords.co.uk

Hemmingfords